

**L - 66**

SECTION 1 Questions 1- 8

Questions 1- 5

Listen to the conversation between the manager of the Student Hostel and a student.

Tick (✓) if the information is correct, or write in the changes.

STUDENT HOSTEL		
Charges for meals		
BREAKFAST	\$2.00	<u>\$2.50</u>
LUNCH	\$3.00	✓
DINNER	\$3.00	(1) _____
THREE MEAL PLAN	\$48.00 per week	(2) _____
TWO MEAL PLAN	\$36.00 per week	(3) _____
Meal Times		
BREAKFAST	7.00 – 9.30 am	(4) _____
LUNCH	noon – 2.00 pm	
DINNER	6.00 – 7.30 pm	(5) _____

Questions 6 – 8

Listen to the conversation and match the places in questions 6-8 to the appropriate letters A-F on the map.

Example: Fees Office Answer B

- 6. Student Lounge \_\_\_\_\_
- 7. Key Room \_\_\_\_\_
- 8. Box Room \_\_\_\_\_

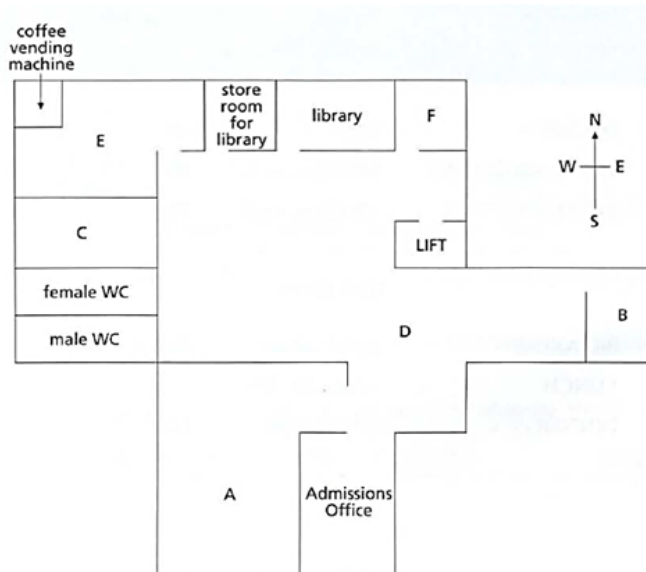

SECTION 2 Questions 9 – 19

Questions 9 -16

Listen while a teacher tells you how to complete this note.

Write NO MORE THAN THREE WORDS OR NUMBERS for each answer.

SCHOOL EXCURSION PERMISSION NOTE

Example

Class: \_\_\_\_\_ 3A \_\_\_\_\_

School excursion to: (9) \_\_\_\_\_

on: (10) \_\_\_\_\_

*day*                      *date*

Bus will depart from: (11) \_\_\_\_\_ at (12) \_\_\_\_\_

Bus will return to: (13) \_\_\_\_\_ at (14) \_\_\_\_\_

Students must bring: (15) \_\_\_\_\_

Clothing: students will need: (16) \_\_\_\_\_

\_\_\_\_\_  
Signature of Guardian / Group Leader

Questions 17-19

Write NO MORE THAN THREE WORDS OR NUMBERS for each answer.

17. When will the bus get to the Blue Mountains? \_\_\_\_\_

18. What special equipment is on the bus? \_\_\_\_\_

19. What other class is going on the excursion? \_\_\_\_\_

SECTION 3 Questions 20 – 30

Questions 20 – 22

Complete the table which shows when visitors may go to the different parts of the hospital.

	Intensive Care	Maternity	Surgical	Emergency
Permitted visiting hours	Example 6 am – midnight	(20) _____	(21) _____	(22) _____

Questions 23 – 25

Complete the table showing who is allowed to visit, and the number of visitors permitted.

A = Adults may visit  
 E = Everyone may visit  
 I = Immediate family only

	Intensive Care	Maternity	Surgical	Emergency
Visitors permitted	Example I 2	(23) _____	(24) _____	(25) _____

Questions 26 – 27

Choose TWO letters.

26. On Tuesday Andrew will be with

- A. Dr Chang
- B. Dr Thomas
- C. Dr Gray
- D. Dr Robertson
- E. Dr Shay
- F. Dr Kominski

27. On Thursday and Friday Andrew will visit

- A. The nursery
- B. The hospital gymnasium
- C. The administration office
- D. The school room
- E. The teenage ward
- F. The children's ward.

Questions 28 – 30

Write NO MORE THAN THREE WORDS OR NUMBERS for each answer.

28. What time on Wednesday morning will Andrew be in lectures? \_\_\_\_\_

29. How many first year students are there? \_\_\_\_\_

30. What job does Andrew's father do? \_\_\_\_\_

SECTION 4                      Questions 31 – 38

Questions 31 – 35

Write NO MORE THAN THREE WORDS to complete these sentences.

31. Samuel Wells \_\_\_\_\_ before Scholastic House opened in 1903.

32. Scholastic House became \_\_\_\_\_ in 1963.

33. There were \_\_\_\_\_ original students.

34. One of these students became a prominent \_\_\_\_\_.

35. The college has a tradition of learning and \_\_\_\_\_.

Questions 36 – 38

Choose the appropriate letter A-D.

36. The college discusses controversial issues because it

- A. Informs the debate
- B. Reduces tension
- C. Encourages argument
- D. Brings positive publicity.

37. The principal believes that

- A. Science is less advanced than medicine
- B. Philosophy is more useful than science
- C. Science is ahead of philosophy
- D. Science is more useful than philosophy.

38. The principal urges the students to

- A. Accept what they are told
- B. Ask questions at all times
- C. Think only about their studies
- D. Think where progress will lead them.

**Answer Key – Listening 66**

1. ✓
2. ✓
3. ✓
4. 7.00-9.00 am
5. 6.00-8.00 pm
6. E
7. F
8. C
9. (The) Blue Mountains
10. Monday / Mon. / June 10 (th) / 10/6
11. (the) front gate
12. 8 am
13. (the) side gate
14. 6 pm
15. (your / their) (own) lunch
16. strong shoes
17. 11 am
18. First Aid kit
19. 3B
20. 8 am-8 pm / 8-8
21. 9 am-9 pm / 9-9
22. 24 hours
23. E (up to) 6
24. A 2
25. E 3
26. B and D
27. E and F
28. 8 to 10 (am)
29. 200 / two hundred
30. a nurse / nursing
31. died (in 1900)
32. co-educational
33. ten / 10
34. teacher / university teacher
35. tolerance / debate / discussion
36. A
37. C
38. D