

L - 50

SECTION 1

Questions 1-10

Complete the table below.

Write ONE WORD AND/OR A NUMBER for each answer.

HOSTELS			
Name	Location	Cost of double room	notes
Hostelling International West End	10 minutes from downtown by: bus	\$50 per night but only \$1.____ for members	Membership card offers discount on entry to 2._____ Internet access costs \$3 per 3._____
4._____ Hostel	Near beach. Two-minute walk to 5._____	\$62. Meals extra but only available in 6._____	Was built as a hotel in 7._____ Can hire 8._____ from hostel
Backpackers Hostel	In 9._____ district	\$45 plus \$5 for breakfast	A 10._____ on every floor for guests to use

SECTION 2

Questions 11-20

Questions 11-15

Label the map below.

Choose FIVE answers from the box and write the correct letter A-H next to questions 11-15.

A	biography	B	fiction	C	magazines	D	newspapers
E	non-fiction	F	photocopiers	G	reference books	H	study area

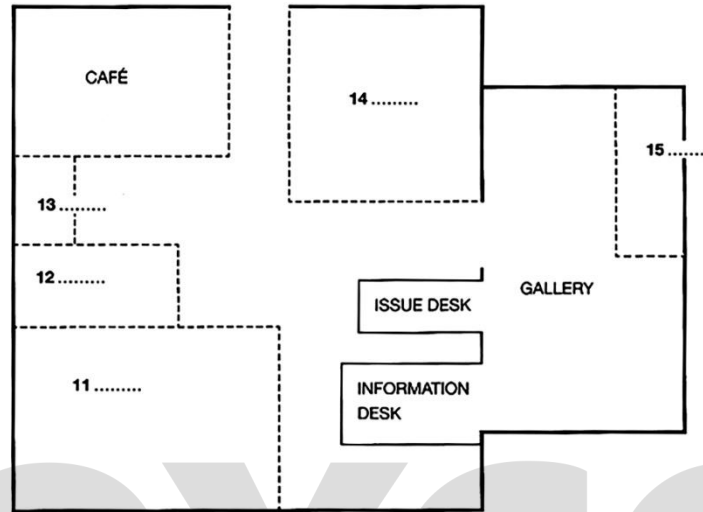

Questions 16-20

16. After two years, library members have to
- A. show proof of their current address.
 - B. pay for a new membership card.
 - C. bring a passport or identity card into the library.
17. What happens if you reserve a book?
- A. It will be available after five days.
 - B. You can collect it a week later.
 - C. You will be contacted when it is available.
18. Which materials can be borrowed for one week only?
- A. some reference books
 - B. CD-ROMs
 - C. children's DVDs
19. On which day does the library stay open later than it used to?
- A. Wednesday
 - B. Saturday
 - C. Sunday
20. Large bags should be left on the
- A. first floor.
 - B. second floor.
 - C. third floor.

SECTION 3

Questions 21-30

Questions 21-25

Choose the correct letter, A, B or C.

21. Why did Anita and Lee choose to talk about John Chapman?
- A. He was Lee's childhood hero.
 - B. They wanted to talk about the USA.
 - C. He was relevant to the topic of their studies.
22. Where did the students record their sources of information?
- A. on their laptops
 - B. on a handout
 - C. on a database
23. The tutor claims she does not understand whether
- A. apples grew in America before Europeans arrived.
 - B. the Native Americans had always eaten apples.
 - C. American apples were first bred in Europe.
24. The tutor says the audience was particularly interested to hear about
- A. grafting techniques in ancient China.
 - B. the cultivation of apples in Kazakhstan.
 - C. the spread of apples along the Silk Route.
25. How will Anita and Lee present their follow-up work?
- A. on the department website
 - B. as a paper
 - C. as a poster

Questions 26-30

What do Lee and Anita agree about their presentation skills with their tutor?

Write the correct letter A, B or C next to questions 26-30.

A	excellent
B	acceptable
C	poor

Presentation skills

26. Use of equipment _____
27. Handling software _____
28. Timing of sections _____
29. Design of handout _____
30. Clarity of speech _____

SECTION 4 Questions 31- 40

Complete the table below.

Write NO MORE THAN ONE WORD for each answer.

INVESTIGATING TASTE		
Cause	Result	Procedure
more yellow added to green colour of 31. _____	subjects believed extra 32. _____ added to drink	brain influenced by product presentation
gum chewed until it is 33. _____ then again with sugar	mint flavor 34. _____	sweetness necessary for mintiness
same drink tasted cold and at room temperature	35. _____ drink seems sweeter	temperature affects sweetness
crisps eaten in rooms which were 36. _____	with louder crunch, subjects believed crisps taste 37. _____	sound affects taste perceptions
variety of cheese sauces prepared	subjects believed some sauces tasted less strong	38. _____ affects taste perceptions
two different flavoured 39. _____ tasted together	subjects still tasted 40. _____ when no longer there	brain is filling the taste 'gap'

Answers – L 50

1. 41
2. museums
3. hour
4. Elliscoat
5. ferry
6. summer
7. 1887
8. scooter(s)
9. entertainment
10. kitchen
11. B
12. H
13. C
14. E
15. A
16. A
17. C
18. C
19. B
20. B
21. C
22. B
23. A
24. C
25. A
26. A
27. B
28. C
29. B
30. A
31. cans
32. lime
33. tasteless
34. returns
35. warm
36. soundproofed
37. fresher
38. texture/thickness
39. liquids
40. strawberry

