

**L - 35**

SECTION 1

Questions 1-10

Questions 1 – 4

Complete the table below. Write ONE WORD AND/OR NUMBERS for each answer.

| Job Hunting                      |   |                  |               |
|----------------------------------|---|------------------|---------------|
| Company's name                   | Job details   | Reference Number | Contact       |
| POWER<br>(manufacturing company) | • work in a 1. _____ section  | SW35FT           | Jane 2. _____ |
| COTTON<br>(grocery company)      | <ul style="list-style-type: none"> <li>• good pay</li> <li>• work</li> </ul> – in 3. _____ office<br><br>– in a 4. _____<br><br>• chance of promotion | 5. _____         | go to office  |

Questions 6 – 10

Complete the notes below. Write ONE WORD ONLY for each answer.

Notes on Jobs

- Local jobs can be found in the 6. \_\_\_\_\_
- Buy the 7. \_\_\_\_\_ to get one free magazine (Job Plus)
- Feel stress and spend a lot of time looking for jobs
- Advisable to go to an 8. \_\_\_\_\_ instead of the recruitment seminar
- Bring a student card (10% discount)
- Referee:
  - former boss (once had a job)
  - one of the 9. \_\_\_\_\_ (if not)
- Intend to take the art course
- Fill out a 10. \_\_\_\_\_ form at the end of the course

SECTION 2 Questions 11-20

Questions 11 – 15

Choose the correct letter, A, B or C.

11. The reason why David is replacing Jane is that
  - A. she is unwell.
  - B. she is very busy.
  - C. she is inexperienced.
12. According to the speaker, what is the problem for the museum currently?
  - A. lack of staff
  - B. lack of publicity
  - C. lack of money
13. Why were the thieves able to successfully steal the statue?
  - A. The security device is outdated.
  - B. The security guard is not well-trained.
  - C. They knew what they were searching for.
14. In order to improve security, they are going to
  - A. get more closed-circuit television cameras.
  - B. hire more security guards.
  - C. buy more computers.
15. What kind of librarian are they looking for?
  - A. responsible
  - B. experienced
  - C. highly-trained

Questions 16 – 20

Label the map below.

Write the correct letter, A-H, next to questions 16-20.

City Museum

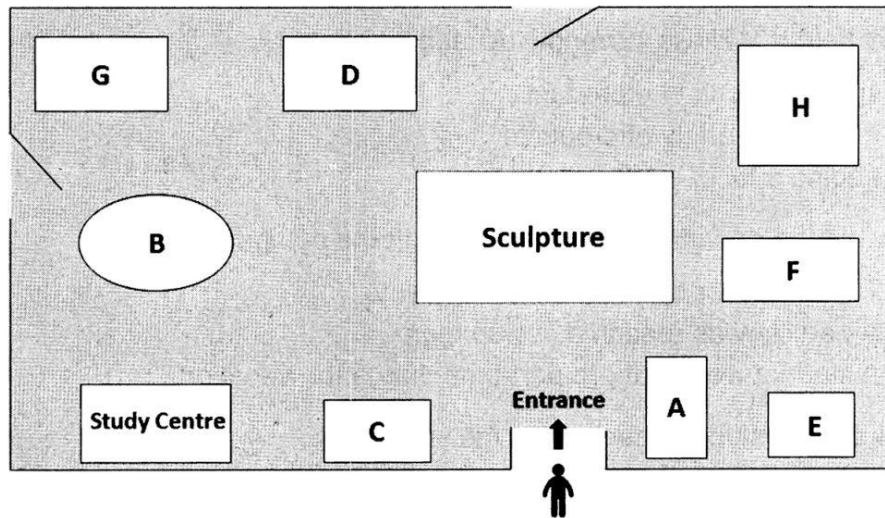

- |                     |       |                     |       |
|---------------------|-------|---------------------|-------|
| 16. Box Office      | _____ | 19. Multimedia Room | _____ |
| 17. Children's Room | _____ | 20. Showroom        | _____ |
| 18. Café            | _____ |                     |       |

SECTION 3

Questions 21-30

Questions 21 – 26

Choose the correct letter, A, B or C.

Willows Studies

21. What field is Willows currently focused on?

- A. Specialising in one product
- B. making a variety of products
- C. adding a lot of retail outlet

22. How did the students feel about the software?

- A. The professor contacted the company.
- B. An article was read in a newspaper
- C. A student work their part-time during the vacations.

23. How did the student fell about the software?

- A. It's not easy to predict.
- B. It's slow for drawing designs
- C. It had a good interface.

24. How did the students find out about the effects of the software on the company?

- A. They went to the IT department.
- B. They talked with the manager.
- C. They inspected the accounts.

25. The reason why the students have a face-to-face interview alone is that

- A. They could prepare for exams.
- B. There will be less disturbance.
- C. It's less realistic.

26. How did the two students perform in the exam?

- A. very disappointing
- B. significantly good
- C. above the average

Questions 27 – 28

Choose TWO letters, A-E.

In which TWO ways will the new system affect the company?

- A. gain more profit
- B. employ more new staff
- C. increase sales
- D. reduce production time
- E. cut labour costs

Questions 29 and 30

Choose TWO letters, A-E

Which TWO effects will the new system have on new clients?

- A. getting more involved in the design
- B. obtaining more contacts
- C. linking at home to do online work
- D. wasting less time
- E. decreasing labour costs

SECTION 4 Questions 31 – 40

Complete the notes below.

Write ONE WORD ONLY for each answer.

A Survey Research

Results of Questionnaire

- The patients preferred to choose the hospital because of the free 31. \_\_\_\_\_ service provided.
- Most patients wished the hospital to be 32. \_\_\_\_\_.
- Patients were concerned about prior 33. \_\_\_\_\_ about the hospital treatment.

Actions in the next year

- improvements on website for local 34. \_\_\_\_\_ as well as hospital medical staff.
- incentive to motivate the members of staff.
- extra 35. \_\_\_\_\_ for staff's success in work.
- considering the opinions of the 36. \_\_\_\_\_.
- improving the effectiveness of 37. \_\_\_\_\_ between patients, doctors and staff.
- first-come-first-served system.

Recommendation

- A new unit would be built for those who are suffering from 38. \_\_\_\_\_ disturbance.
- A new ward would be proposed to those in need of 39. \_\_\_\_\_ surgery.
- The equipment is advanced enough to do with the treatments.
- More effective 40. \_\_\_\_\_ is needed to improve the efficiency of communication.

**Answers – L 35**

1. warehouse
2. Hitcher
3. supermarket
4. bakery
5. ARW204
6. adverts / advertisements
7. newspaper
8. agency
9. tutors
10. feedback
11. A
12. B
13. C
14. A
15. B
16. C
17. B
18. E
19. H
20. G
21. A
22. B
23. A
24. C
25. B
26. C
27. & 28. B, E (IN EITHER ORDER)
29. & 30. A, D (IN EITHER ORDER)
31. transportation
32. clean
33. information
34. residents
35. bonus
36. visitors
37. communication
38. sleep
39. plastic
40. planning

