

L - 1

SECTION 1 Questions 1-10

Questions 1-6

Complete the notes.

Write NO MORE THAN THREE WORDS OR A NUMBER for each answer.

School Excursion	
Day: Wednesday	
Destination: 1. _____	
Weather: 2. _____	
Arrival time: 3. _____	
Activities Planned	
See: 4. _____	
Eat: Catered lunch	
Attend: 5. _____	
Return time: 6. _____	

Questions 7-10

Complete the table

Write ONE WORD ONLY for each answer.

Nationality	%
7. _____	26
8. _____	25
9. _____	16
Indonesian	15
10. _____	8
Saudi	7
Other	3

SECTION 2 Questions 11-20

Questions 11 – 15

Choose the correct letter, A, B, or C.

11. The company deals mostly with:
  - A. Big cities.
  - B. Nature holidays.
  - C. Nepal.
12. The overseas consultants deal mostly with:
  - A. Asia.
  - B. North America.
  - C. Europe.
13. For deserts and gorges, customers should come in the:
  - A. Morning.
  - B. Afternoon.
  - C. Night.
14. Trips to regional locations are good because:
  - A. The buses are comfortable.
  - B. There is storage for suitcases.
  - C. They can be seen quickly.
15. SleekLine buses are particularly known for their:
  - A. Service.
  - B. Size.
  - C. Comfort.

Questions 16-20

Identify the rooms in the office plan.

Write the correct letter, A-G, next to the questions.

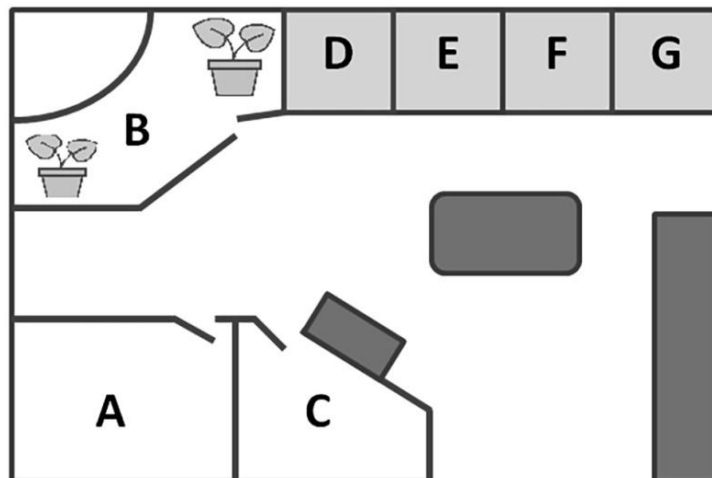

- |                         |       |                    |       |
|-------------------------|-------|--------------------|-------|
| 16. Local Tours         | _____ | 19. Asian Region   | _____ |
| 17. Interstate Tours    | _____ | 20. General Office | _____ |
| 18. International Tours | _____ |                    |       |

SECTION 3

Questions 21-30

Questions 21 – 24

Complete the timetable.

Write the correct letter, A-H, for each answer.

	Morning	Afternoon
Monday	Opening Lecture	21. _____
Tuesday	22. _____	Study Skills
Wednesday	X	23. _____
Thursday	X	X
Friday	X	24. _____

A. BBQ	B. Careers lecture	C. Computer lab visit	D. Dance
E. Library tour	F. Student Union induction	G. University tour	H. Legal rights lecture

Questions 25-30

Complete the labels.

Write ONE WORD OR A NUMBER for each answer.

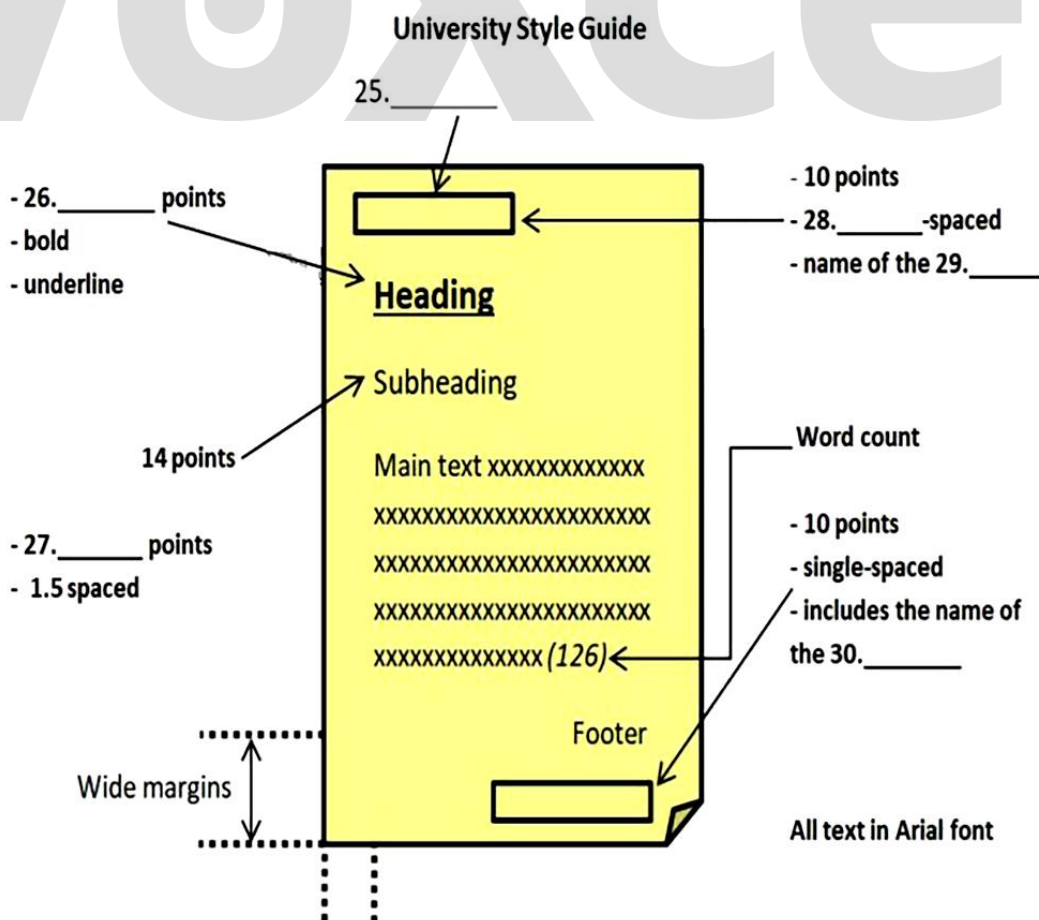

SECTION 4

Questions 31-40

Questions 31-34

Complete the sentences.

Write NO MORE THAN TWO WORDS for each answer.

Behavior in parks is controlled by 31. \_\_\_\_\_

Insect numbers are reduced by having 32. \_\_\_\_\_

A wilderness park does not have any 33. \_\_\_\_\_

Observing trees and lying in the grass are examples of 34. \_\_\_\_\_

Questions 35-40

Complete the notes.

Write NO MORE THAN TWO WORDS OR A NUMBER for each answer.

PARKS

<p>1000 years ago</p>	<p>sufficient wilderness</p> <p>large forests: people could 35. _____</p> <p>desire to preserve nature began with 36. _____</p>
<p>Princes Park</p>	<p>land originally worth £ 37. _____</p> <p>designed by Joseph Paxton</p> <p>in the middle was a 38. _____</p>
<p>Neighborhood Parks</p>	<p>now regarded as a 39. _____</p> <p>satisfy a natural desire</p> <p>can be famous, e.g. in 40. _____</p>

**Answers – L1**

1. (the) Animal Park
2. Cold and cloudy
3. 10.15 am
4. Birds of prey
5. (the) reptile display
6. 6.30 pm
7. Chinese
8. Japanese
9. Korean(s)
10. Thai
11. B
12. A
13. B
14. C
15. A
16. D
17. F
18. B
19. C
20. A
21. G
22. E
23. C
24. A
25. Header
26. 16
27. 12
28. Single
29. Work
30. Teacher
31. Regulations
32. Short grass
33. Development
34. Passive recreation
35. Get lost
36. Industrial Revolution
37. 50,000
38. (central) lake
39. Refuge
40. Melbourne

