

CBL 11.2

Section 1

Questions 1-10

Complete the notes below.

Write ONE WORD AND/OR A NUMBER for each answer.

Enquiry about joining Youth Council

Name: Roger Brown

Age: 18

Currently staying in a 1. \_\_\_\_\_ during the week

Postal address: 17, 2. \_\_\_\_\_ Street, Stamford, Lincs

Postcode: 3. \_\_\_\_\_

Occupation: student and part time job as a 4. \_\_\_\_\_

Studying 5. \_\_\_\_\_ (major subject) and history (minor subject)

Hobbies: does a lot of 6. \_\_\_\_\_, and is interested in the 7. \_\_\_\_\_

On Youth Council, wants to work with young people who are 8. \_\_\_\_\_

Will come to talk to the Elections Officer next Monday at 9. \_\_\_\_\_ pm

Mobile number: 10. \_\_\_\_\_

Section 2

Questions 11-20

New staff at theatre

Questions 11 and 12

Choose TWO letters A-E.

Which TWO changes have been made so far during the refurbishment of the theatre?

- A. Some rooms now have a different use.
- B. A different type of seating has been installed.
- C. An elevator has been installed.
- D. The outside of the building has been repaired.
- E. Extra seats have been added.

Questions 13 and 14

Choose TWO letters, A-E.

Which TWO facilities does the theatre currently offer to the public?

- A. rooms for hire
- B. backstage tours
- C. hire of costumes
- D. a bookshop
- E. a café

Questions 15 and 16

Choose TWO letters, A-E.

Which TWO workshops does the theatre currently offer?

- A. sound
- B. acting
- C. making puppets
- D. make-up
- E. lighting

Questions 17-20

Label the plan below. Write the correct letter A-G, next to questions 17-20.

Ground floor plan of theatre

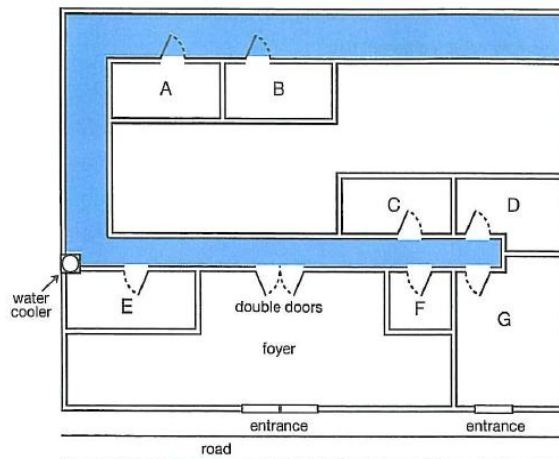

17. box office \_\_\_\_\_

19. lighting box \_\_\_\_\_

18. theatre manager's office \_\_\_\_\_

20. artistic director's office \_\_\_\_\_

Section 3

Questions 21-30

Questions 21-26

Choose the correct letter A, B or C.

Rocky Bay field trip

21. What do the students agree should be included in their aims?

- A. factors affecting where organisms live
- B. the need to preserve endangered species
- C. techniques for classifying different organisms

22. What equipment did they forget to take on the Field Trip?

- A. string
- B. a compass
- C. a ruler

23. In Helen's procedure section, Colin suggests a change in

- A. the order in which information is given
- B. the way the information is divided up
- C. the amount of information provided

24. What do they say about the method they used to measure wave speed?

- A. It provided accurate results
- B. It was simple to carry out
- C. It required special equipment

25. What mistake did Helen make when first drawing the map?

- A. She chose the wrong scale
- B. She stood in the wrong place
- C. She did it at the wrong time

26. What do they decide to do next with their map?

- A. scan it onto a computer
- B. check it using photographs
- C. add information from the internet

Questions 27 and 28

Choose TWO letters A-E.

Which TWO problems affecting organisms in the splash zone are mentioned?

- A. lack of water
- B. strong winds
- C. lack of food
- D. high temperatures
- E. large waves

Questions 29 and 30

Choose TWO letters, A-E.

Which TWO reasons for possible error will they include in their report?

- A. inaccurate records of the habitat of organisms
- B. influence on behaviour of organisms by observer
- C. incorrect identification of some organisms
- D. making generalisations from a small sample
- E. missing some organisms when counting

Section 4

Questions 31-40

Complete the notes below.

Write ONE WORD ONLY for each answer.

DESIGNING A PUBLIC BUILDING:

THE TAYLOR CONCERT HALL

Introduction

The designer of a public building may need to consider the building's:

- Function
- Physical and 31. \_\_\_\_\_ context
- Symbolic meaning

Location and concept of the Concert Hall

- On the site of a discussed 32. \_\_\_\_\_
- Beside a 33. \_\_\_\_\_
- The design is based on the concept of a mystery

Building design

- It's approached by a 34. \_\_\_\_\_ for pedestrians
- The building is the shape of a 35. \_\_\_\_\_
- One exterior wall acts as a large 36. \_\_\_\_\_

In the auditorium:

- The floor is built on huge pads made of 37. \_\_\_\_\_
- The walls are made of local wood and are 38. \_\_\_\_\_ in shape
- Ceiling panels and 39. \_\_\_\_\_ on walls allow adjustment of acoustics

Evaluation

- Some critics say the 40. \_\_\_\_\_ style of building is inappropriate

**Answers – CB L 11.2**

1. Hostel
2. Buckleigh
3. PE9 7QT
4. Waiter
5. Politics
6. Cycling
7. Cinema
8. Disabled
9. 4.30 (pm)/ half past four
10. 07788 136711
11. & 12. A, B (IN EITHER ORDER)
13. & 14. B, D (IN EITHER ORDER)
15. & 16. C, E (IN EITHER ORDER)
17. G
18. D
19. B
20. F
21. A
22. A
23. C
24. B
25. B
26. B
27. & 28. A, D (in either order)
29. & 30. C, E (in either order)
31. Social
32. Factory
33. Canal
34. Bridge
35. Box
36. Screen
37. Rubber
38. Curved
39. Curtains
40. International

